



# LD1625-5-1

## ●Specifications:

Wavelength: 1625nm  
 Power: 5mW CW  
 Package: TO18

## ●Absolute Maximum Ratings( $T_c=25^\circ\text{C}$ ):

Parameter		Symbols	Ratings	Units
Light Output	CW	$P_o$	5	mW
	Reverse Voltage	Laser	$V_r$	2
		PD	-	V
Operation Temperature		$T_{op}$	10~+30	$^\circ\text{C}$
Storage Temperature		$T_{stg}$	-40~+85	$^\circ\text{C}$

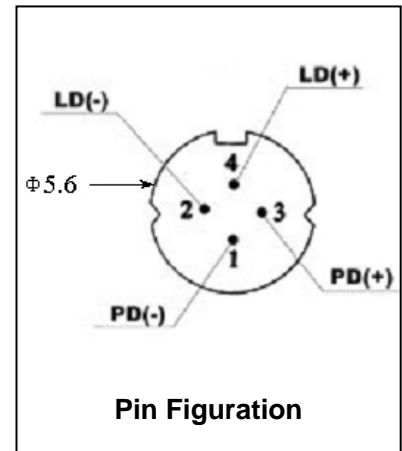

## ●Electrical and Optical Characteristics( $T_c=25^\circ\text{C}$ ):

Parameter		Symbols	Condition	Min.	Typ.	Max.	Unit
Lasing Wavelength		$\lambda_p$	-	1600	1625	1650	nm
Spectral Width		$\Delta\lambda$	-	-	3	-	nm
Emitter Size		-	-	4x1			$\mu\text{m}$
Wavelength / Temperature		-	-	-	0.3	-	nm/ $^\circ\text{C}$
Threshold Current		$I_{th}$	-	-	15	-	mA
Operating Current		$I_{op}$	-	-	50	-	mA
Operating voltage		$V_{op}$	-	-	2.0	-	V
Beam <sup>1)</sup> Divergence	Parallel	$\theta_{//}$	-	-	20	-	deg.
	Perpendicular	$\theta_{\perp}$	-	-	40	-	deg.
Slope Efficiency		$\eta$	-	0.12	-	-	mW/mA

1) Full angle at half Maximum





Tel: (+86) 577-8181-0885  
 Fax: (+86)577-8826-3363  
 www.z-optics.com  
 Sales@z-optics.com

●Dimensions:

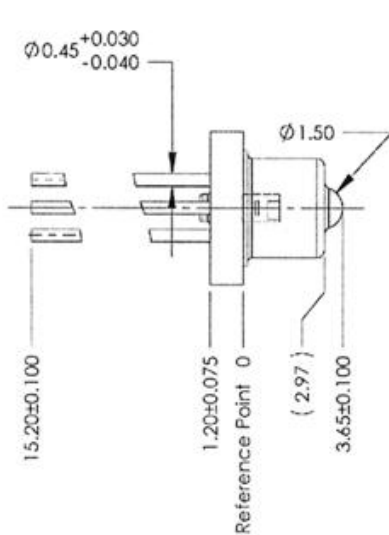

Ball Lens Windows

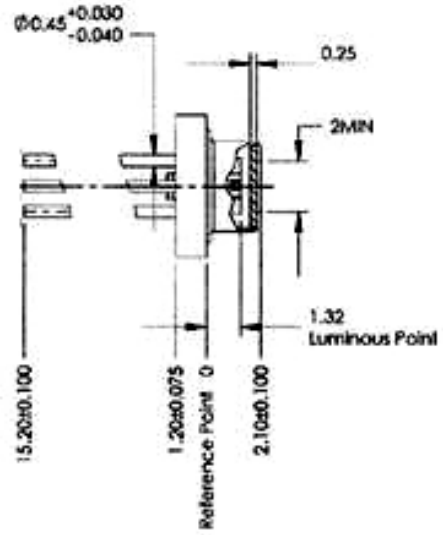

Flat Windows

●Typical Characteristic Curve:

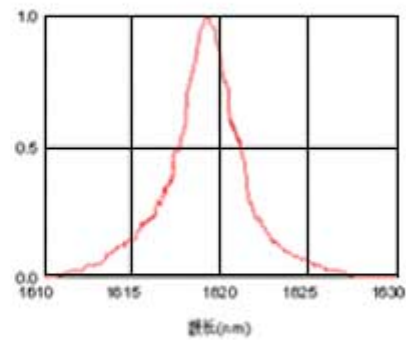
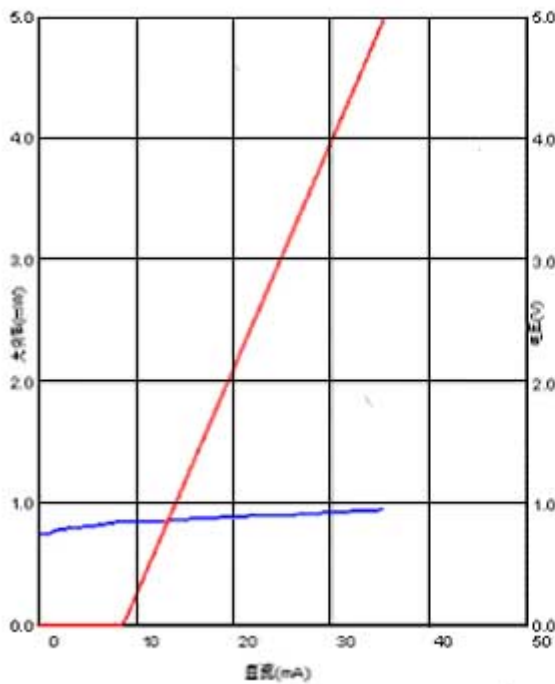

Z-Optics Co., Ltd.  
 Hailong Building C301, Xiaonan Road  
 Wenzhou, Zhejiang Province  
 325028, China  
 Company Code: 3102282052763